

Graphic Installation

Pop Up Display

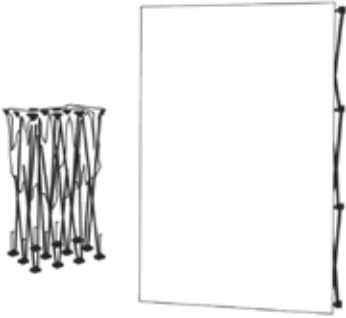

WARNING! DO NOT FORCE CLOSED.
To avoid damage, all hooks must be disconnected before collapsing frame.

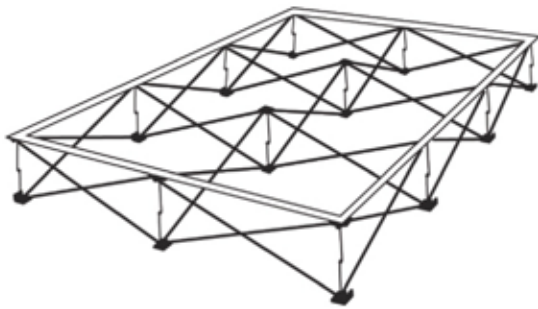

1

Assemble frame and lay flat on its back.
Remove existing graphic.

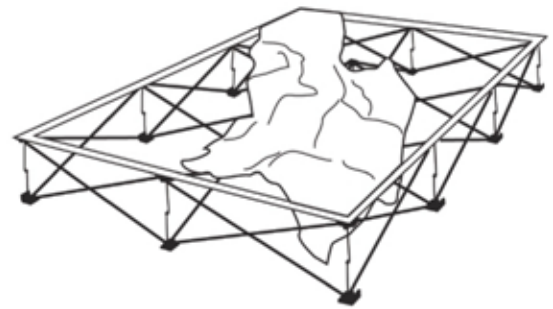

2

Starting at one corner, attach velcro on graphic to velcro on frame.
Overlap velcro of graphic a 1/4" on all sides of velcro of frame.
Note: Velcro should not be flush.

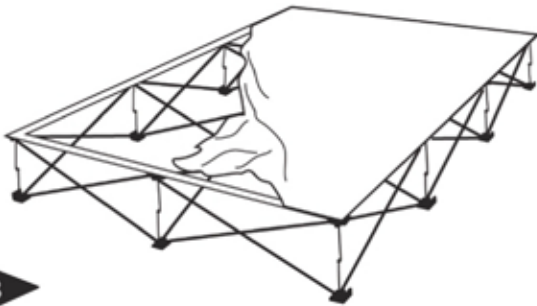

3

Work in continuous direction around the frame
until graphic is completely attached.



4

If needed, adjust velcro for taut fit.

Setup Instructions

Pop Up Display

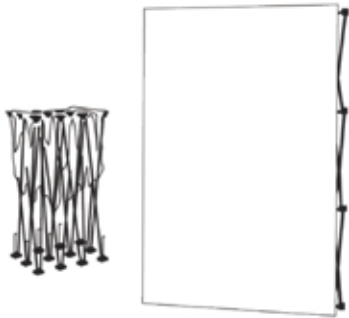

WARNING! DO NOT FORCE CLOSED.
To avoid damage, all hooks must be disconnected before collapsing frame.



1

Remove frame and graphic from bag.



2

Ensure "adjustable knobs" of frame are on the floor. Pull up display into upright position.

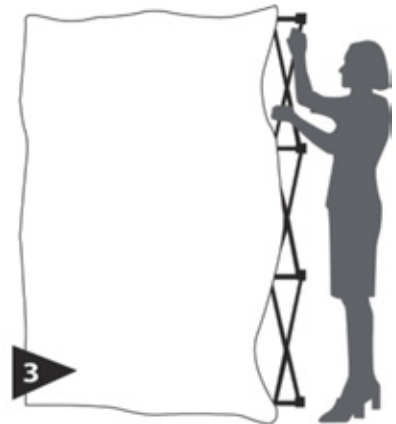

3

Lock all hooks between front and back hubs.

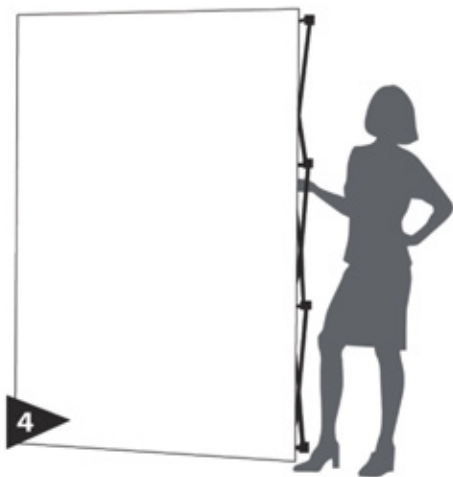

4

Adjust leveling knobs for desired angle. OneFabric™ display can now be moved easily into position.

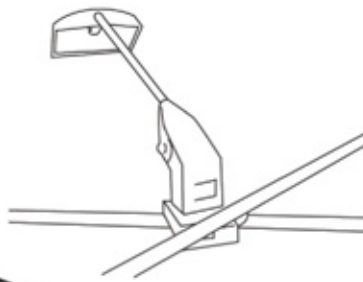

5

OPTIONAL

Attach lights to top of frame by sliding the plastic X Blocks under the frames cross sections.